

Traditional Door Lock



Features

- This **Traditional Door Lock** has been designed to replace most existing front door locks, providing added security to new exterior and interior doors
- Suitable for left or right handed operation, inward or outward* opening doors
- A simple snib button deadlocks the latch from the inside
- 60mm sized backset
- Green, Brassed or Chrome finishes available
- Green finish available with a Brass or Satin cylinder
- Supplied with three cut keys

* For outward opening doors, the staple must be purchased separately (only available in green)



Traditional Door Lock

Ordering Details

Traditional Door Lock

Part No.

Finish	Clam Version	Boxed Version
--------	--------------	---------------

Green Body, Brass Cylinder	133-82	133-81
Green Body, Satin Cylinder	135-82	135-81
Brassed Body, Brass Cylinder	133-32	133-31
Chrome Body, Chrome Cylinder	136-62	136-61

Accessories

Finish	Part No.
--------	----------

Outward Striker Plate (Green)	SP133-STRIKER
-------------------------------	---------------

Packaging

Boxed version

1 lock per inner box, 12 locks per outer box. 0.67Kg per item, 8.04Kg per outer box.

Clam version

Plastic packaging with euro hooks. 1 lock per clam, 10 per outer box. 0.64Kg per item, 6.4Kg per outer box.

Maintenance

Wipe the surface periodically with a soft cloth to remove excess grease or moisture.

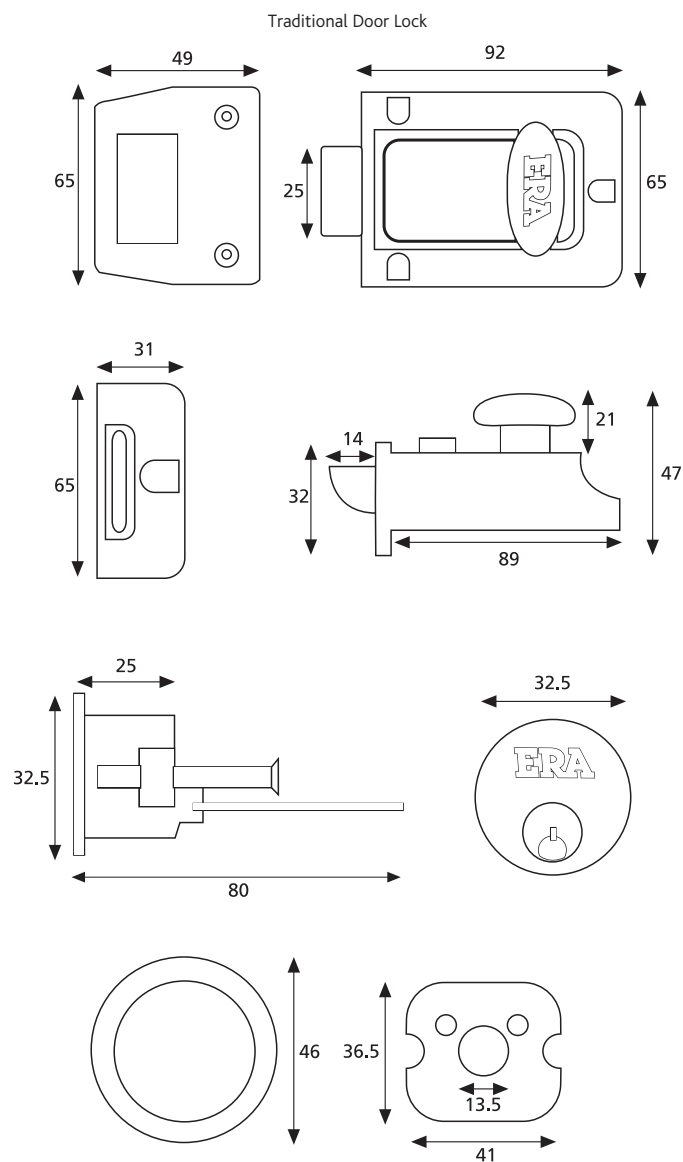

All dimensions are in mm.

ERA reserves the right to change specification without notice.

It is the responsibility of the door manufacturer to ensure that the finished product meets any required safety and performance specification